

Technical Manual



JBL CSS8018

SPECIFICATIONS

ACOUSTIC & ELECTRICAL SPECIFICATIONS:

- Nominal Impedance: 8 Ohms
- Driver Power Handling: 20W
- Frequency Range (- 10 dB):
Driver/Grille Assembly: 50 Hz - 17 kHz
Installed in CSS-BB
BACKCAN: 90 Hz - 17 kHz
- Driver Sensitivity (mid-range)
(1W [2.83V], 1m, 2k - 6k Hz):97 dB

SYSTEM COMPONENTS:

- Transducer: 200 mm (8 in) speaker, 25 mm (1 in) diameter voice coil with a Kapton™ coil-former
- DC Resistance: 7.8 ohm

AURAL SWEEP TEST SPECIFICATIONS:

A. System Aural Sweep Test: 25V Input (2.5W Tap), 50 Hz to 18 kHz

PHYSICAL SPECIFICATIONS:

- Net Weight (ea): 3.5 lb (1.58 kg.)

WARRANTY INFORMATION:

- Refer to Warranty Statement packed with each product.
- Transformer Taps:

	Orange	Green	Gray	Yellow	Black
25V	1.3W	2.5W	5W	10W	COM
	White	Blue	Brown	Orange	Black
70V	1.3W	2.5W	5W	10W	COM
100V	2.5W	5W	10W	N/C	COM

PACKAGE

- Warranty Card
59660
- Instruction Sheet
445673-001
- Carton
445678-001
- Inner Carton
445677-001
- Inside Carton Wrap
Liner
455676-001
- Main PE Bag
445674-001

Accessory Bag
445675-001

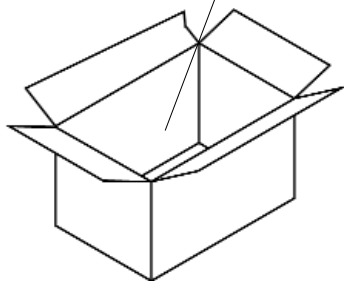

COMPONENT EXPLODED VIEW

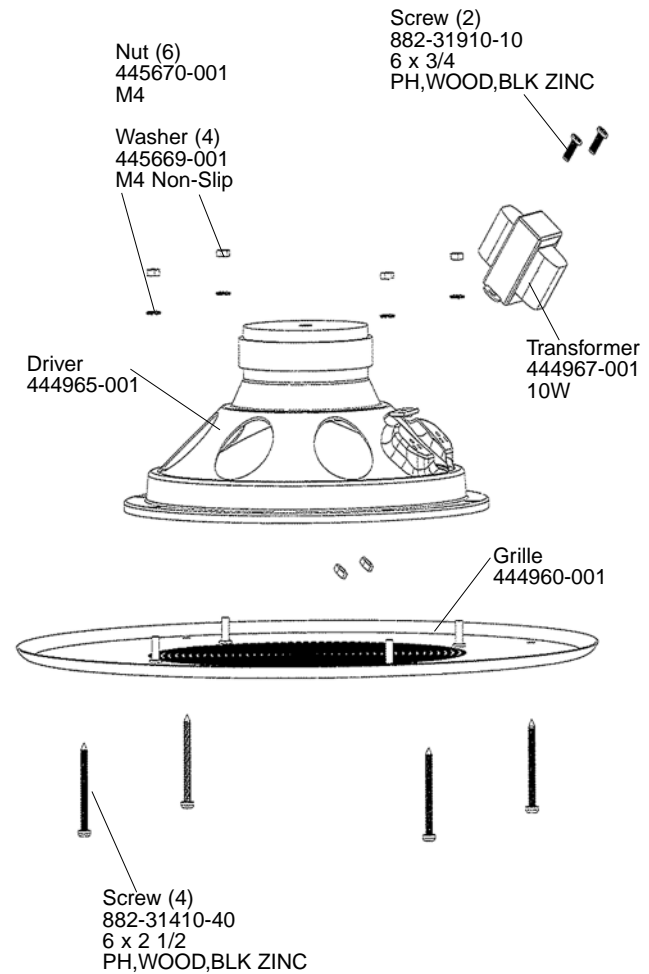

JBL CSS8018 REV A